

### Características

<b>Campo de aplicação</b>	Swage nipple for HD 100 HD 200 KP 100 to KP 600 TE hoses NY hoses TF hoses Suction hoses
<b>Conexão 1</b>	rosca fêmea métrica
<b>Tipo de vedação 1</b>	cone exterior 24° com o-ring
<b>Série</b>	leve
<b>Material</b>	aço
<b>Proteção de superfície</b>	com revestimento galvanizado
<b>Norma</b>	ISO 8434-1
<b>Customs tariff number</b>	73079910

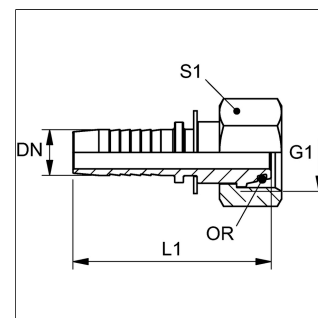

### Indicação

Selecione o terminal adequado de acordo com o tipo de mangueira.

### Artigo

Designação	DN	Taman ho	Polegada	G1	Pressã o opera cional (bar)	L1 (mm)	para Ø externo do tub o em (mm)	S1	OR
PN 04 AOL	5	3	3/16"	M 12 x 1,5	415	45.5	6	14	4,0 x 1,5
PN 04 AOL 06	5	3	3/16"	M 14 x 1,5	450	45.5	8	17	6,0 x 1,5
PN 04 AOL 08	5	3	3/16"	M 16 x 1,5	420	46	10	19	7,5 x 1,5
PN 06 AOL 04	6	4	1/4"	M 12 x 1,5	415	46.5	6	14	4,0 x 1,5
PN 06 AOL	6	4	1/4"	M 14 x 1,5	450	52	8	17	6,0 x 1,5
PN 06 AOL 08	6	4	1/4"	M 16 x 1,5	420	52	10	19	7,5 x 1,5
PN 06 AOL 10	6	4	1/4"	M 18 x 1,5	385	53	12	22	9,0 x 1,5
PN 08 AOL 06	8	5	5/16"	M 14 x 1,5	450	47	8	17	6,0 x 1,5
PN 08 AOL	8	5	5/16"	M 16 x 1,5	420	52	10	19	7,5 x 1,5
PN 08 AOL 10	8	5	5/16"	M 18 x 1,5	385	53	12	22	9,0 x 1,5
PN 08 AOL 13	8	5	5/16"	M 22 x 1,5	420	58	15	27	12,0 x 2,0
PN 10 AOL 06	10	6	3/8"	M 14 x 1,5	450	50.5	8	17	6,0 x 1,5
PN 10 AOL 08	10	6	3/8"	M 16 x 1,5	420	51.5	10	19	7,5 x 1,5
PN 10 AOL	10	6	3/8"	M 18 x 1,5	385	54.5	12	22	9,0 x 1,5
PN 10 AOL 13	10	6	3/8"	M 22 x 1,5	420	56.5	15	27	12,0 x 2,0
PN 13 AOL 10	12	8	1/2"	M 18 x 1,5	385	54.5	12	22	9,0 x 1,5
PN 13 AOL	12	8	1/2"	M 22 x 1,5	420	57.5	15	27	12,0 x 2,0
PN 13 AOL 16	12	8	1/2"	M 26 x 1,5	350	59	18	32	15,0 x 2,0
PN 16 AOL 13	16	10	5/8"	M 22 x 1,5	420	58	15	27	12,0 x 2,0
PN 16 AOL	16	10	5/8"	M 26 x 1,5	350	64	18	32	15,0 x 2,0
PN 16 AOL 20	16	10	5/8"	M 30 x 2	380	64.5	22	36	20,0 x 2,0
PN 20 AOL 16	19	12	3/4"	M 26 x 1,5	350	66.5	18	32	15,0 x 2,0
PN 20 AOL	19	12	3/4"	M 30 x 2	380	71	22	36	20,0 x 2,0
PN 20 AOL 25	19	12	3/4"	M 36 x 2	280	73	28	41	26,0 x 2,0
PN 25 AOL 20	25	16	1"	M 30 x 2	380	75.5	22	36	20,0 x 2,0

Designação	DN	Tamanho	Polegada	G1	Pressão operacional	L1	para Ø externo do tubo em	S1	OR
PN 25 AOL	25	16	1"	M 36 x 2	280	81	28	41	26,0 x 2,0
PN 25 AOL 32	25	16	1"	M 45 x 2	210	85.5	35	50	32,0 x 2,5
PN 32 AOL 25	31	20	1.1/4"	M 36 x 2	280	87	28	41	26,0 x 2,0
PN 32 AOL	31	20	1.1/4"	M 45 x 2	210	94.5	35	50	32,0 x 2,5
PN 32 AOL 40	31	20	1.1/4"	M 52 x 2	160	94.5	42	60	38,0 x 2,5
PN 40 AOL 32	38	24	1.1/2"	M 45 x 2	210	94	35	50	32,0 x 2,5
PN 40 AOL	38	24	1.1/2"	M 52 x 2	160	98	42	60	38,0 x 2,5
PN 50 AOL 40	51	32	2"	M 52 x 2	160	112.5	42	60	38,0 x 2,5

DN = diâmetro nominal

### Outras versões

PN AOL VA	Terminal para prensar, DKOL
-----------	-----------------------------